

M18 LED Handrail light

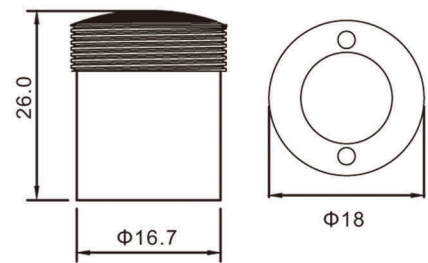

Symmetric

LED handrail lighting system, suit for standard handrail made by stainless steel and aluminum. Different colors from 2700- 6500K and blue for LEDs are available, IP67 waterproof.

Suit for Standard Ø38-100mm handrail wall thickness >1.5mm for a M18 hole 3M waterproof internal connectors Can be driven by 12V and 24V LED power supply Aluminum anodized or stainless steel housing Customized sizes, shape and beam angle on request

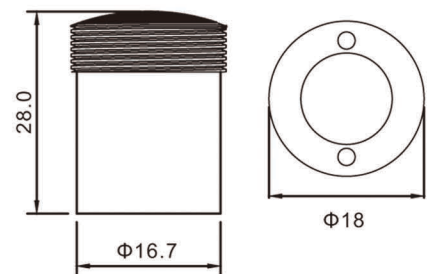

Asymmetric

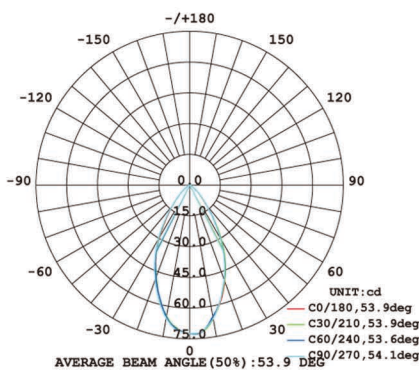

Light Distribution Curve
Symmetric

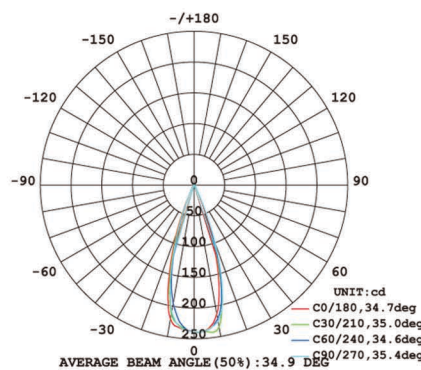

Light Distribution Curve
Symmetric

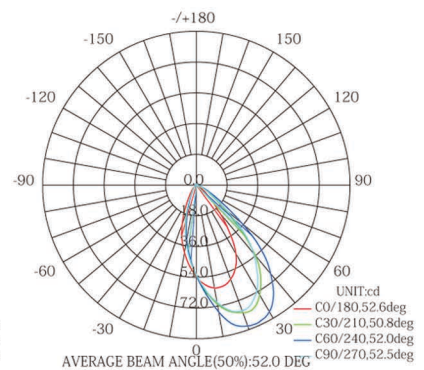

Light Distribution Curve
Asymmetric



M18 LED Handrail light

Connection Diagram:

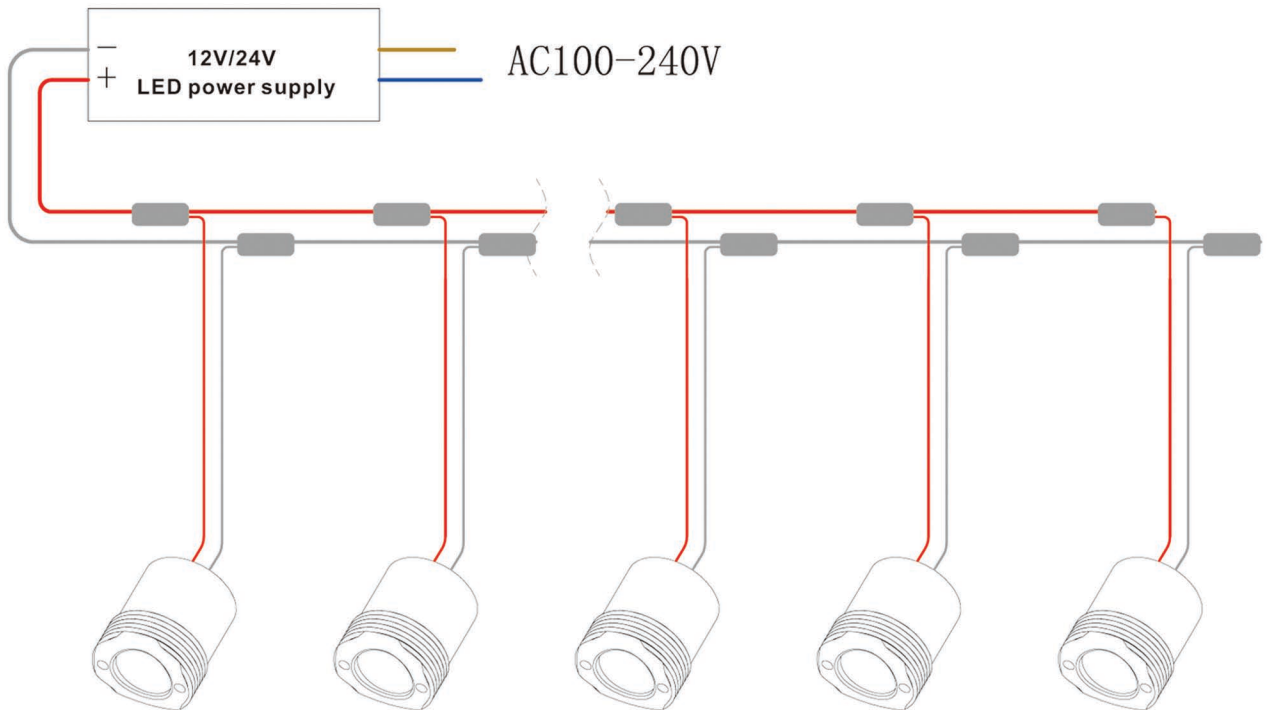

Fixing step:

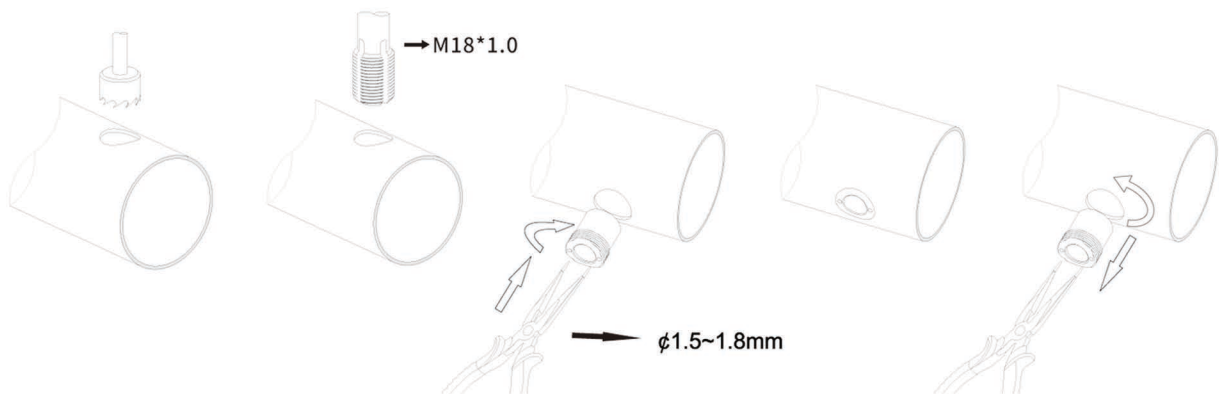

Drill a hole with M18*1mm thread base on the dimension of LED handrail light, turn round the handrail light with thread, then it is fixed.