

M25 LED Handrail light

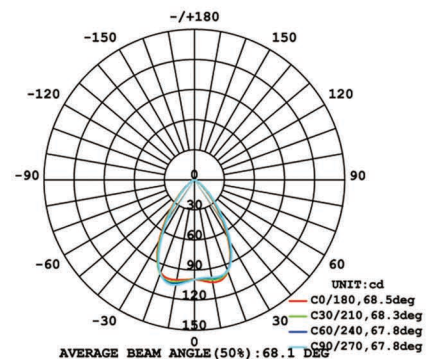

Suit for Standard Ø48-63mm handrail
wall thickness 1.0-1.5mm for a Ø27 hole
3M waterproof internal connectors
Can be driven by 12V and 24V LED power supply
stainless steel housing
Customized sizes,
shape and beam angle on request

LED handrail lighting system,
suit for standard handrail made by stainless
steel and aluminum.
Different colors from 2700- 6500K and blue
for LEDs are available, IP67 waterproof.

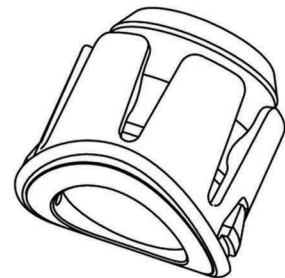
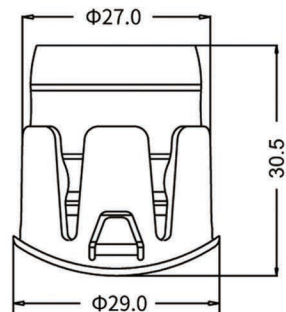

Light Distribution Curve
Symmetric

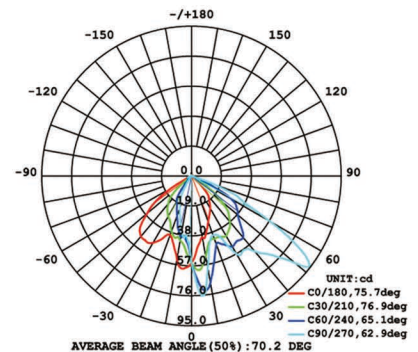

Light Distribution Curve
Asymmetric

